

RELEVU C1 - ETAJ 5

Scara 1:100

Nr. Cadastral al terenului	Suprafata utila (mp)	Adresa imobilului	
	375.63	Constanta, Blv. Aurel Vlaicu, Nr. 265 A	
Cartea Funciara colectiva nr.		CF individuala	
Cod unitate individuala (UI)		UAT	CONSTANTA

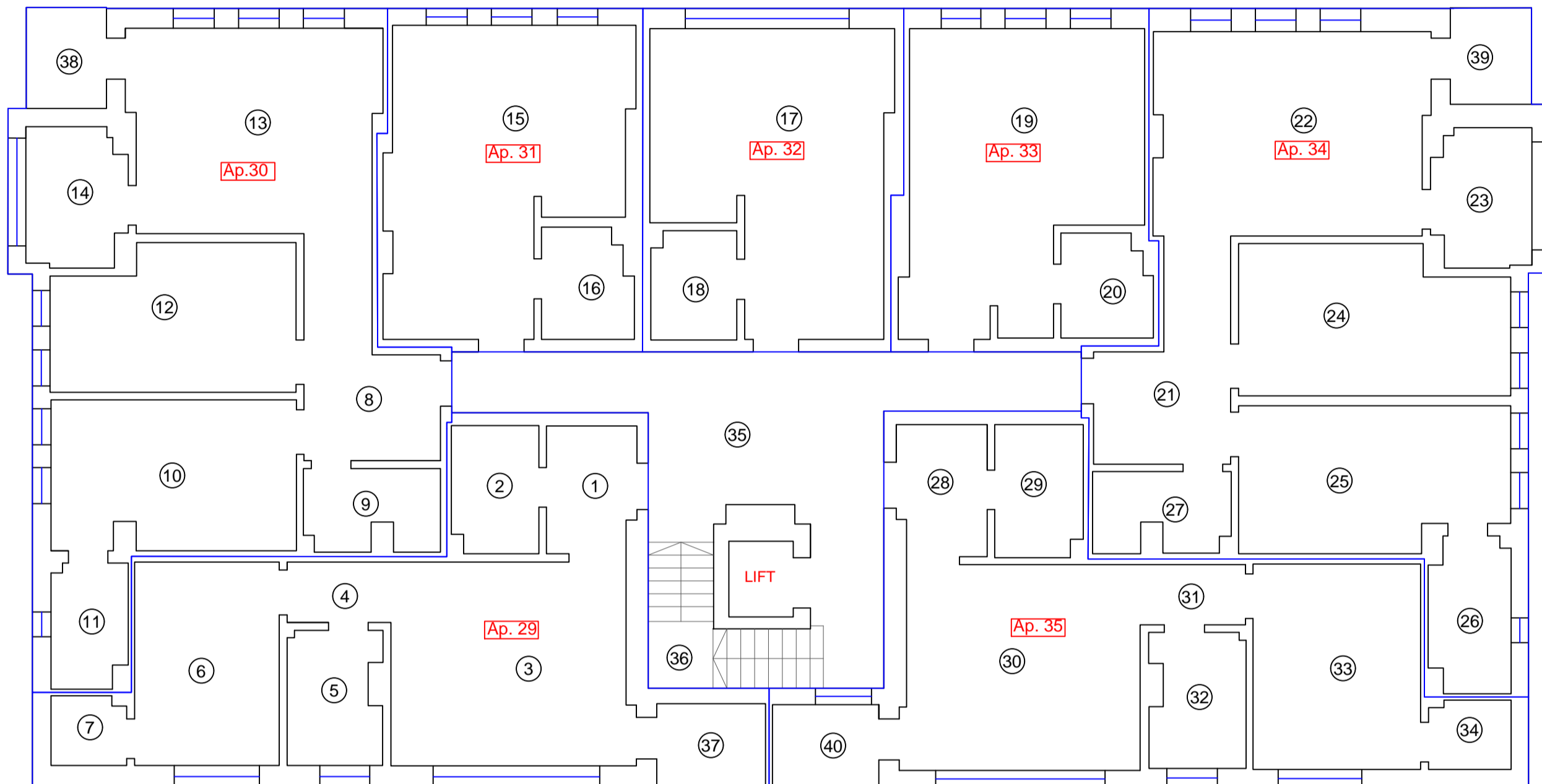

Nr. incapere	Denumire incapere	Suprafata utila [mp]	Executant
Suprafata construita Ap. 29 = 69.38 mp			S.C. GEOCAD LIMITS S.R.L.
1	Hol	4.77	
2	Baie	4.49	
3	Living	19.83	
4	Hol	2.56	
5	Bucatarie	5.00	
6	Camera	12.00	
7	Dresing	2.09	
Suprafata utila Ap. 29 = 50.74 mp			
37	Balcon	3.74	
Suprafata totala Ap. 29 = 54.48 mp			
Suprafata construita Ap. 30 = 91.27 mp			Decembrie 2016
Apartment 30			
8	Hol	9.29	
9	Baie	4.33	
10	Camera	14.86	
11	Baie	3.78	
12	Camera	13.87	
13	Living	20.55	
14	Bucatarie	5.47	
Suprafata utila Ap. 30 = 72.15 mp			
38	Balcon	3.30	
Suprafata totala Ap. 30 = 75.45 mp			
Apartment 31			Receptionat
15	Living+Bucatarie	26.18	
16	Baie	3.96	
Suprafata utila Ap. 31 = 30.14 mp			
Suprafata totala Ap. 31 = 30.14 mp			
Apartment 32			
17	Living+Bucatarie	25.46	
18	Baie	3.76	
Suprafata utila Ap. 32 = 29.22 mp			
Suprafata totala Ap. 32 = 29.22 mp			
Apartment 33			
19	Living+Bucatarie	25.73	
20	Baie	3.70	
Suprafata utila Ap. 33 = 29.43 mp			
Suprafata totala Ap. 33 = 29.43 mp			
Apartment 34			
21	Hol	9.45	
22	Living	22.57	
23	Bucatarie	5.42	
24	Camera	15.74	
25	Camera	15.35	
26	Baie	4.96	
27	Baie	4.26	
Suprafata utila Ap. 34 = 77.75 mp			
39	Balcon	3.20	
Suprafata totala Ap. 34 = 80.95 mp			
Apartment 35			
28	Hol	4.93	
29	Baie	4.82	
30	Living	19.83	
31	Hol	2.60	
32	Bucatarie	5.12	
33	Camera	14.07	
34	Dresing	2.29	
Suprafata utila Ap. 28 = 53.66 mp			
40	Balcon	3.61	
Suprafata totala Ap. 28 = 57.27 mp			
Parti comune Etaj 5			
35	Hol	30.77	
36	Casa scarii	1.77	
Suprafata totala parti comune Etaj 5 = 32.54 mp			
Suprafata construita parti comune etaj 5 = 42.04 mp			Data