

RELEVEU C1 - ETAJ 6

Scara 1:100

Nr. Cadastral al terenului	Suprafata utila (mp)	Adresa imobilului	
	374.67	Constanta, Blv. Aurel Vlaicu, Nr. 265 A	
Cartea Funciara colectiva nr.		CF individuala	
Cod unitate individuala (UI)		UAT	CONSTANTA

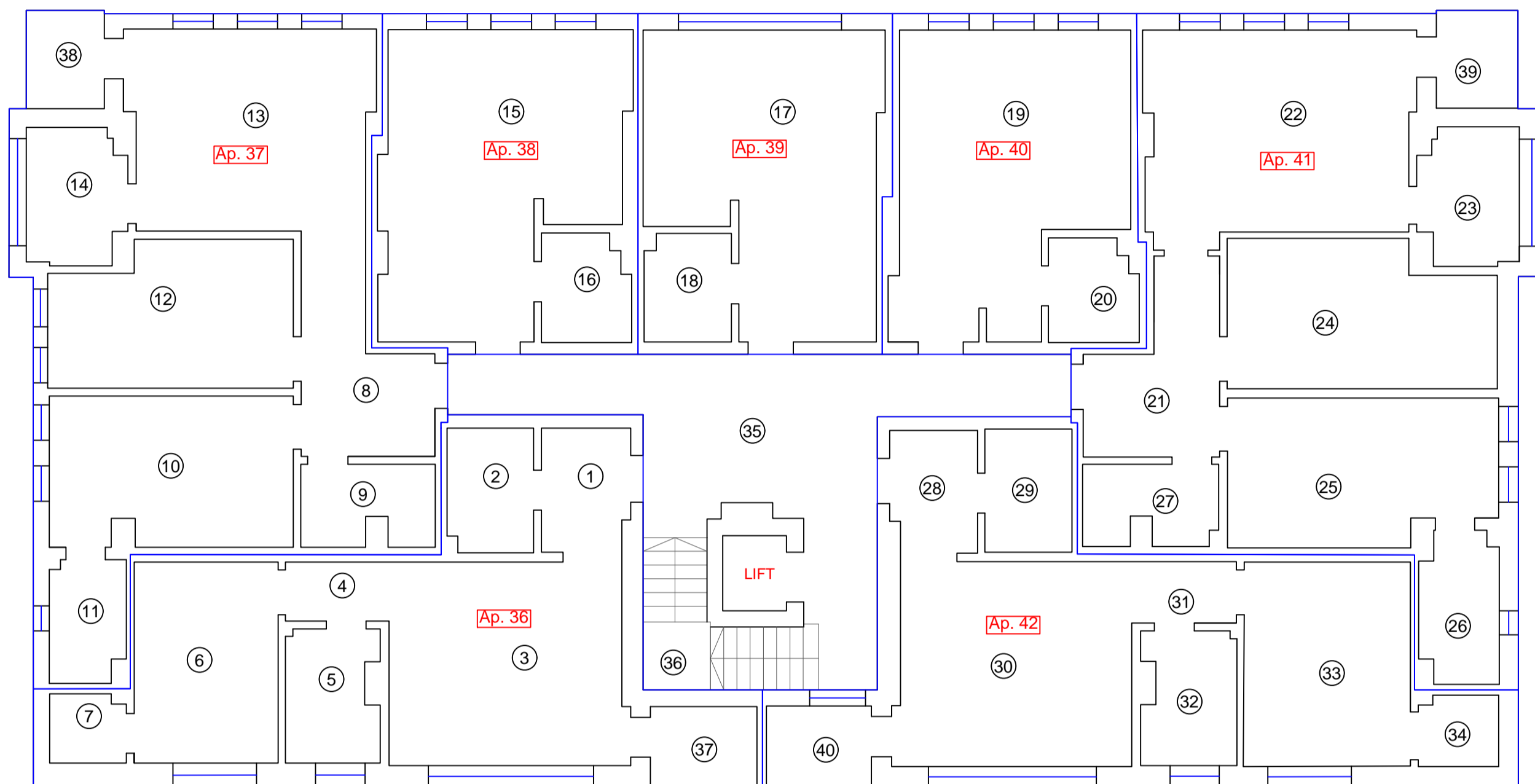

Nr. incapere	Denumire incapere	Suprafata utila [mp]	Executant
Suprafata construita Ap. 36 = 69.89 mp			S.C. GEOCAD LIMITS S.R.L.
Apartment 36			
1	Hol	4.73	
2	Baie	4.40	
3	Living	19.84	
4	Hol	2.56	
5	Bucatarie	4.96	
6	Camera	11.98	
7	Dresing	2.13	
Suprafata utila Ap. 36 = 50.60 mp			
37	Balcon	3.56	
Suprafata totala Ap. 36 = 54.16 mp			
Apartment 37			
Suprafata construita Ap. 37 = 90.03 mp			
8	Hol	8.96	
9	Baie	4.34	
10	Camera	15.02	
11	Baie	3.76	
12	Camera	13.94	
13	Living	20.00	
14	Bucatarie	5.38	
Suprafata utila Ap. 37 = 71.40 mp			
38	Balcon	3.18	
Suprafata totala Ap. 37 = 74.58 mp			
Apartment 38			
Suprafata construita Ap. 38 = 36.86 mp			
15	Living+Bucatarie	26.93	
16	Baie	3.84	
Suprafata utila Ap. 38 = 30.77 mp			
Suprafata totala Ap. 38 = 30.77 mp			
Apartment 39			
Suprafata construita Ap. 39 = 35.26 mp			
17	Living+Bucatarie	25.79	
18	Baie	3.85	
Suprafata utila Ap. 39 = 29.64 mp			
Suprafata totala Ap. 39 = 29.64 mp			
Apartment 40			
Suprafata construita Ap. 40 = 35.49 mp			
19	Living+Bucatarie	25.95	
20	Baie	3.70	
Suprafata utila Ap. 40 = 29.65 mp			
Suprafata totala Ap. 40 = 29.65 mp			
Apartment 41			
Suprafata construita Ap. 41 = 98.06 mp			
21	Hol	8.49	
22	Living	22.76	
23	Bucatarie	5.45	
24	Camera	15.48	
25	Camera	15.74	
26	Baie	4.71	
27	Baie	4.29	
Suprafata utila Ap. 41 = 76.92 mp			
39	Balcon	3.30	
Suprafata totala Ap. 41 = 80.22 mp			
Apartment 42			
Suprafata construita Ap. 42 = 72.00 mp			
28	Hol	4.53	
29	Baie	4.44	
30	Living	19.86	
31	Hol	2.66	
32	Bucatarie	5.08	
33	Camera	14.07	
34	Dresing	2.32	
Suprafata utila Ap. 42 = 52.96 mp			
40	Balcon	3.53	
Suprafata totala Ap. 42 = 56.49 mp			
Parti comune Etaj 6			
35	Hol	30.84	
36	Casa scarii	1.89	
Suprafata totala parti comune Etaj 6 = 32.73 mp			
			Receptionat
			Data